

DUNHAM SURVEYING, S. C.
SURVEYING & SUBDIVIDING
DELAVAN, WISCONSIN 53115

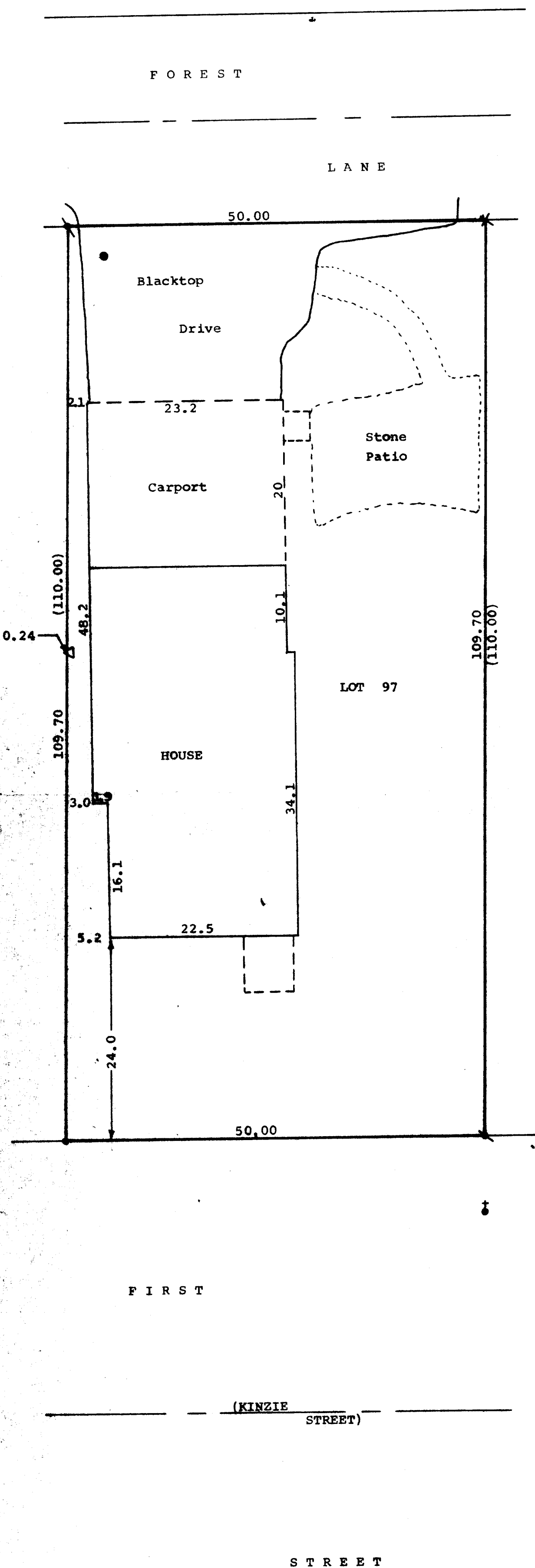

Scale - 1" = 10'
 # = Iron Pipe Found
 o = Iron Pipe Set
 X = Spike in Tree
 Δ = T.V. Antenna
 ● = Manhole
 X = Telephone Pole
 (0.00) = Recorded Distance
 0.00 = Field Measurement

STATE OF WISCONSIN)
 COUNTY OF WALWORTH) SS

I, James M. Dunham, Surveyor, certify that I have surveyed the property described as follows,
 Lot 97 of Buena Vista, a subdivision located in the Village of Fontana-on-Geneva Lake, Walworth County, Wisconsin,
 and that the above map is a true representation thereof and shows the size and location of the property, its exterior boundaries, the location of all visible structures and dimensions of all principal buildings thereon, boundary fences, apparent easements, roadways and visible encroachments, if any. This survey is made for the use of the present owners of the property, and also those who purchase, mortgage, or guarantee the title thereto within one (1) year from date hereof.
 September 23, 1980

James M. Dunham
 James M. Dunham, Surveyor

